

MODEL 147

Current Transformer

Window Diameter 10.00"



REGULATORY AGENCY APPROVALS



Manufactured to meet the requirements of ANSI/IEEE C57.13.
Classified by U.L. in accordance with IEC 44-1

Application

Relaying and metering.

Frequency

50-400 Hz

Insulation Level

600 Volt, 10 kV BIL full wave.

Lower ratios available upon request.

Terminals are brass screws No. 10-32 with one flatwasher and lockwasher.

Short time thermal rating factor:
75 x rated primary current for 1 second.

For indoor service, in black plastic case.

Approximate weight 50 lbs.

Model 147

CATALOG NUMBER	CURRENT RATIO	RELAY CLASS	ANSI METERING CLASS AT 60 Hz					RATING FACTOR AT 30°C AMBIENT	SECONDARY WINDING RESISTANCE (Ω @ 75°C)
			B0.1	B0.2	B0.5	B0.9	B1.8		
147-202	2,000:5	C200	0.3	0.3	0.3	0.3	0.3	2.0	0.414
147-252	2,500:5	C200	0.3	0.3	0.3	0.3	0.3	2.0	0.447
147-302	3,000:5	C200	0.3	0.3	0.3	0.3	0.3	2.0	0.495
147-402	4,000:5	C200	0.3	0.3	0.3	0.3	0.3	2.0	0.707
147-502	5,000:5	C200	0.3	0.3	0.3	0.3	0.3	2.0	0.745
147-602	6,000:5	C400	0.3	0.3	0.3	0.3	0.3	1.5	0.975
147-802	8,000:5	C400	0.3	0.3	0.3	0.3	0.3	1.0	1.970
147-103	10,000:5	C400	0.3	0.3	0.3	0.3	0.3	1.0	2.190

Model 147

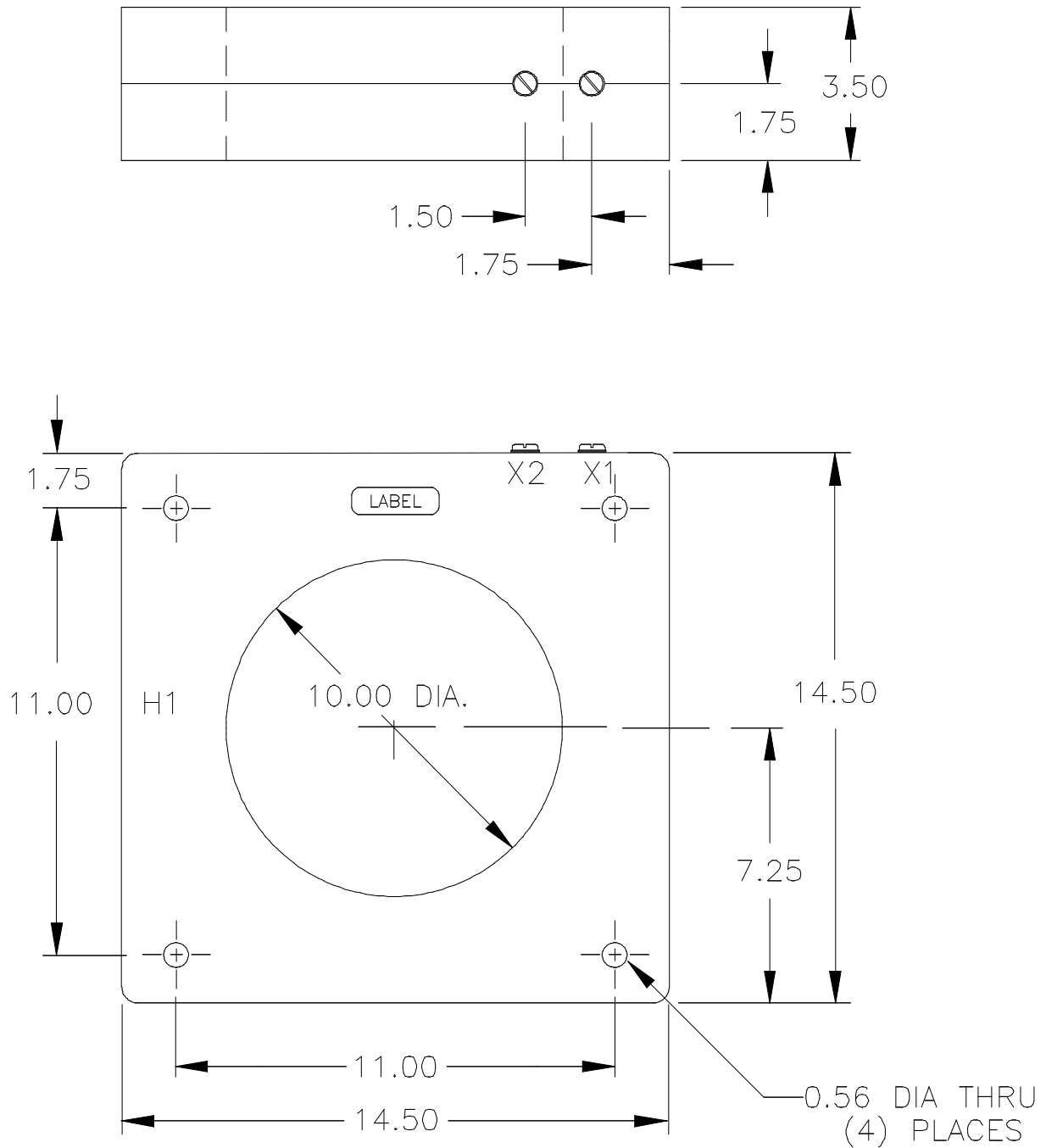

For more information, visit
gevernova.com/grid-solutions

Instrument Transformers LLC reserve the right to change specifications of described products at any time without notice and without obligation to notify any person of such changes.

© 2025 GE Vernova and/or its affiliates. All rights reserved. GE and the GE Monogram are trademarks of General Electric Company used under trademark license.



GE VERNOVA

GEA-N50409
English
251008