

# MODEL 58

## Current Transformer

Window Diameter 1.25"

### Application

With ammeters, wattmeters, and cross current compensation.

### Frequency

50-400 Hz.

### Insulation Level

600 Volt, 10 kV BIL full wave.

### Model 58

| CATALOG NUMBER | CURRENT RATIO | ACCURACY AT 60 Hz | BURDEN VA AT 60 Hz |
|----------------|---------------|-------------------|--------------------|
| 58**-500       | 50:5          | ±3%               | 1.5                |
| 58**-600       | 60:5          | ±2%               | 2.5                |
| 58**-750       | 75:5          | ±1.5%             | 2.5                |
| 58**-800       | 80:5          | ±1%               | 2.5                |
| 58**-101       | 100:5         | ±1.5%             | 5.0                |
| 58**-121       | 120:5         | ±1%               | 5.0                |
| 58**-1250      | 125:5         | ±1%               | 6.0                |
| 56**-151       | 150:5         | ±1%               | 7.5                |



Model 58RL Shown



Flexible leads are UL 1015, 105°C, CSA approved, #16 AWG, 24" long.

Non-standard length to be specified.

Terminals are brass studs No. 8-32 with one flat washer, lock washer and regular nut.

Approximate weight 1.3 lbs.

| CATALOG NUMBER | CURRENT RATIO | ACCURACY AT 60 Hz | BURDEN VA AT 60 Hz |
|----------------|---------------|-------------------|--------------------|
| 58**-201       | 200:5         | ±1%               | 12.5               |
| 58**-251       | 250:5         | ±1%               | 12.5               |
| 58**-301       | 300:5         | ±1%               | 15.0               |
| 58**-401       | 400:5         | ±1%               | 25.0               |
| 58**-501       | 500:5         | ±1%               | 25.0               |
| 58**-601       | 600:5         | ±1%               | 25.0               |
| 58**-751       | 750:5         | ±1%               | 25.0               |
| 58**-801       | 800:5         | ±1%               | 25.0               |

\*\*Note: When ordering, prefix Cat No. with model designation required i.e. 58RL—101, 58RBL—251, etc.

## Model 58

*Model 58RT*

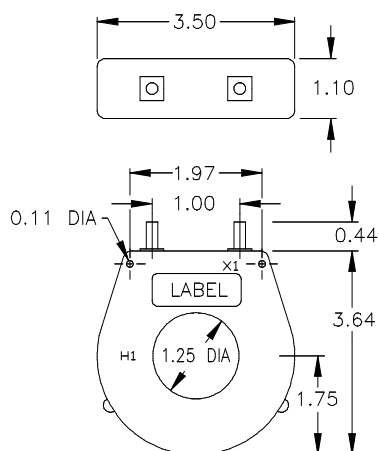

*Model 58RBT*

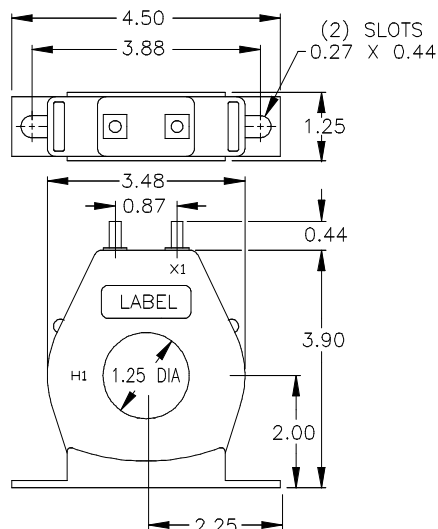

*Model 58RL*

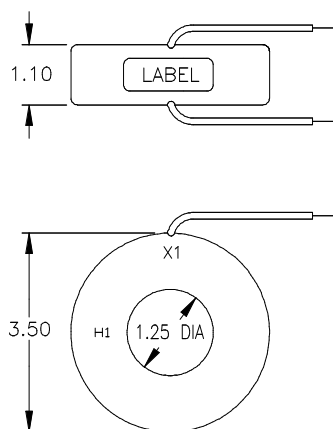

*Model 58RBL*

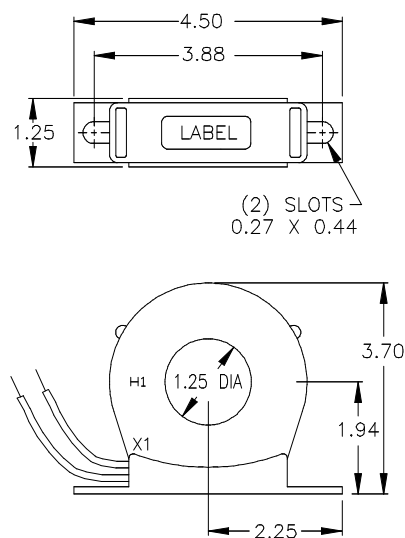

For more information, visit  
[gevernova.com/grid-solutions](https://www.gevernova.com/grid-solutions)

Instrument Transformers LLC reserve the right to change specifications of described products at any time without notice and without obligation to notify any person of such changes.

© 2025 GE Vernova and/or its affiliates. All rights reserved. GE and the GE Monogram are trademarks of General Electric Company used under trademark license.



**GE VERNOVA**

GEA-N50730  
 English  
 250918