

# MODELS 14, 15, 16

## Current Transformers

Window Diameter 0.64", 0.94", 1.25"



Model 15RT shown



### Application

With ammeters, energy management systems, and instrumentation.

### Frequency

50-400 Hz.

### Insulation Level

600 Volt, 10 kV BIL full wave.

Terminal are brass studs No. 8-32 with one flatwasher, lockwasher and regular nut.

Flexible leads are UL 1015, 105 °C, CSA approved, #16 AWG, 24" long.

Non-standard, lead length can be specified.

SFT case style also available as SFL with leads.

Approximate weight 0.9 lbs

Data Table: Models 14, 15, 16

CATALOG NUMBER	CURRENT RATIO	ACCURACY AT 60 Hz	BURDEN VA AT 60 Hz	DIM "A"
14**-500	50:5	±1.5%	2.5	0.50
14**-600	60:5	±1.5%	2.5	
14**-750	75:5	±1.5%	2.5	
14**-800	80:5	±1.0%	2.5	
14**-101	100:5	±1.0%	3.0	
15**-500	50:5	±1.5%	2.0	0.94
15**-600	60:5	±1.5%	2.0	
15**-750	75:5	±1.5%	2.5	
15**-800	80:5	±1.0%	2.0	
15**-101	100:5	±1.0%	2.0	
15**-121	120:5	±1.0%	3.0	
15**-1250	125:5	±1.0%	4.0	
15**-151	150:5	±1.0%	5.0	
15**-1750	175:5	±1.0%	10	
15**-201	200:5	±1.0%	12.5	

CATALOG NUMBER	CURRENT RATIO	ACCURACY AT 60 Hz	BURDEN VA AT 60 Hz	DIM "A"
16**-500	50:5	±2%	1.5	1.25
16**-600	60:5	±2%	1.5	
16**-750	75:5	±2%	3.0	
16**-800	80:5	±2%	3.0	
16**-101	100:5	±1%	3.0	
16**-121	120:5	±1%	4.0	
16**-1250	125:5	±1%	5.0	
16**-151	150:5	±1%	6.0	
16**-1750	175:5	±1%	7.0	
16**-201	200:5	±1%	8.0	
16**-251	250:5	±1%	10	
16**-301	300:5	±1%	10	
16**-401	400:5	±1%	15	

**\*\*Note:** When ordering, prefix Cat No. with model designation required i.e. 14RL-600, 15SFT-151, 16RT-151, etc.

## Models 14, 15, 16

**RBT Style**

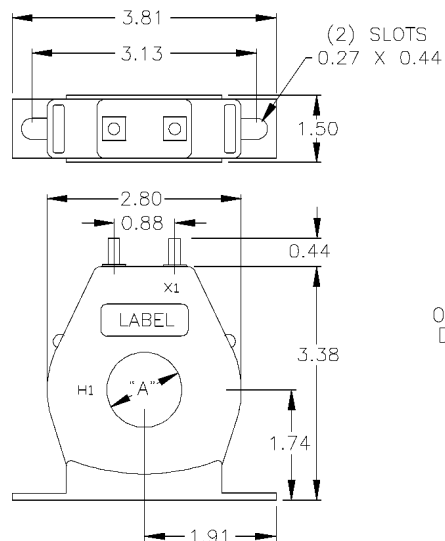

**RT Style**

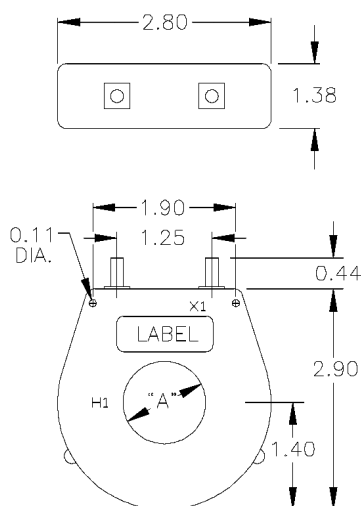

**RBL Style**

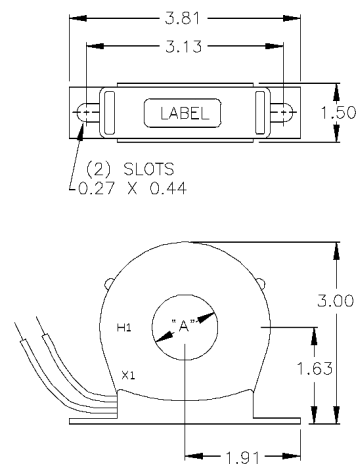

**RL Style**

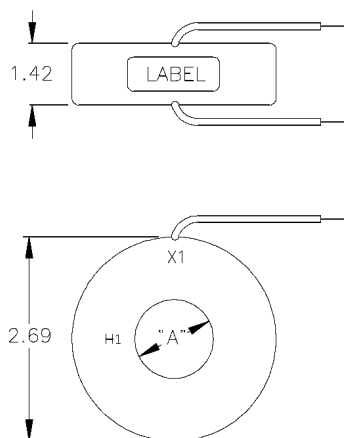

**SFT Style**

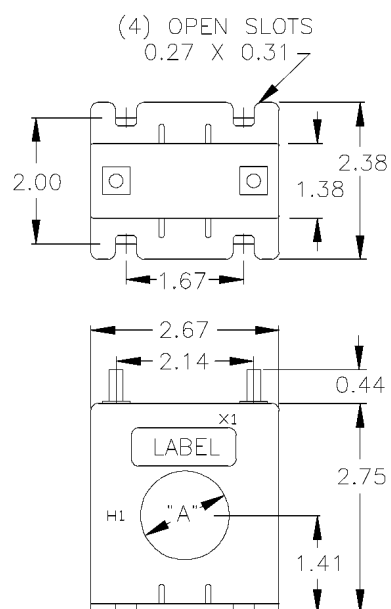

For more information, visit  
[gevernova.com/grid-solutions](http://gevernova.com/grid-solutions)

Instrument Transformers LLC reserve the right to change specifications of described products at any time without notice and without obligation to notify any person of such changes.

© 2025 GE Vernova and/or its affiliates. All rights reserved. GE and the GE Monogram are trademarks of General Electric Company used under trademark license.



**GE VERNOVA**

GEA-N50369  
 English  
 251008