

MODEL 137MR

Current Transformer with Multi-Ratio

Window Diameter 5.50"



Application

Relaying.

Frequency

50-400 Hz.

Insulation Level

600 Volt, 10 kV BIL full wave.

Terminals are brass screws No. 10-32 with one flatwasher and lockwasher.

The transformer winding is arranged so that the turns are fully distributed between all taps.

Order mounting bracket kit 0221B01528 separately.

Approximate weight 50 lbs.

Model 137 MR

CATALOG NUMBER	RELAY CLASS	CONTINUOUS THERMAL RATING FACTOR	
		@ 30°C	@ 55°C
137-601MR	C200	2.0	2.0
137-122MR	C400	2.0	1.5
137-202MR	C400	1.5	1.0
137-302MR	C400	1.33	1.0
137-402MR	C400	1.0	0.8
137-502MR	C400	0.6	0.3

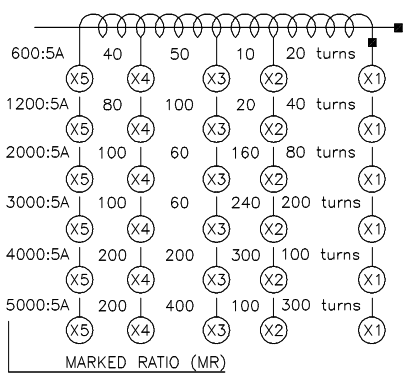
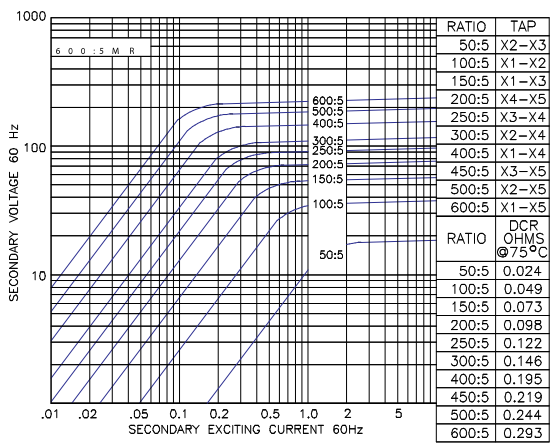

137MR

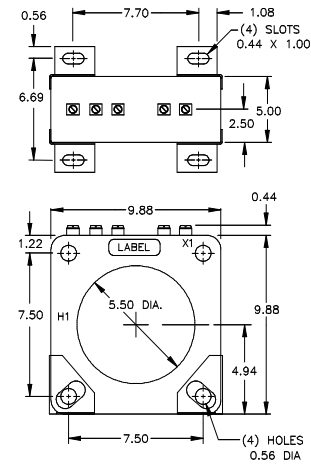
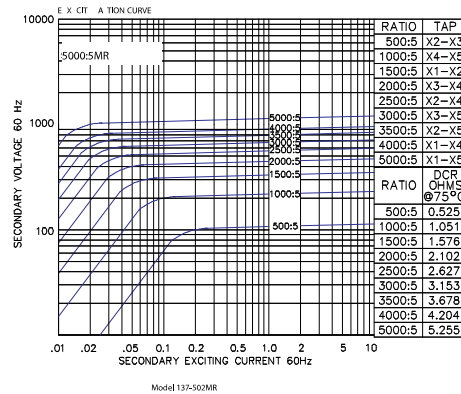
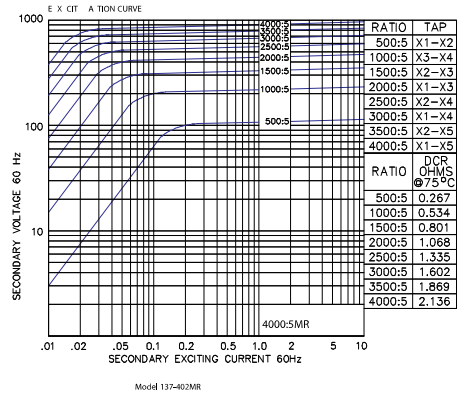
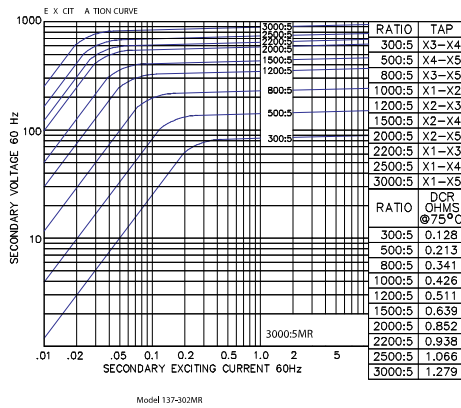
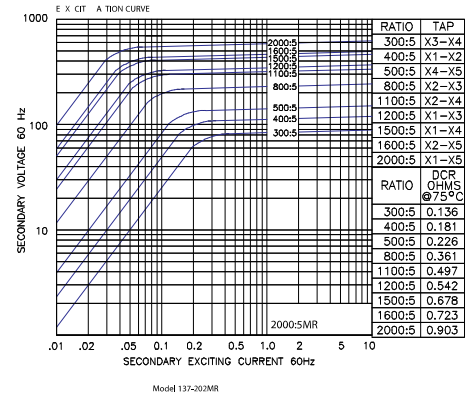
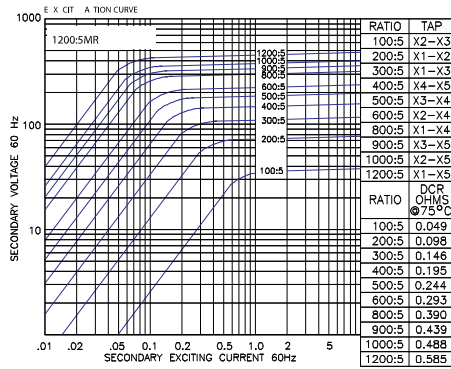

For more information, visit
gevernova.com/grid-solutions

Instrument Transformers LLC reserve the right to change specifications of described products at any time without notice and without obligation to notify any person of such changes.

© 2025 GE Vernova and/or its affiliates. All rights reserved. GE and the GE Monogram are trademarks of General Electric Company used under trademark license.



GE VERNOVA

GEA-N50765
 English
 251009