

MODEL 590

Current Transformer

Window Size 4.28" x 11.28"



Application

Relaying.

Frequency

50-400 Hz.

Insulation Level

600 Volts, 10 kV BIL full wave.

Continuous Thermal Current Rating Factor

2.0 at 30°C. amb., 2.0 at 55°C. amb.

Terminals are brass screws No. 10-32 with one flatwasher and lockwasher accessible from both sides.

Approximate weight 70 lbs.

Excitation data available upon request.

Model 590

CATALOG NUMBER	CURRENT RATIO	RELAY CLASS
590-500	50:5	C15
590-750	75:5	C25
590-101	100:5	C35
590-151	150:5	C50
590-201	200:5	C70
590-301	300:5	C100
590-401	400:5	C150
590-501	500:5	C180

Model 590

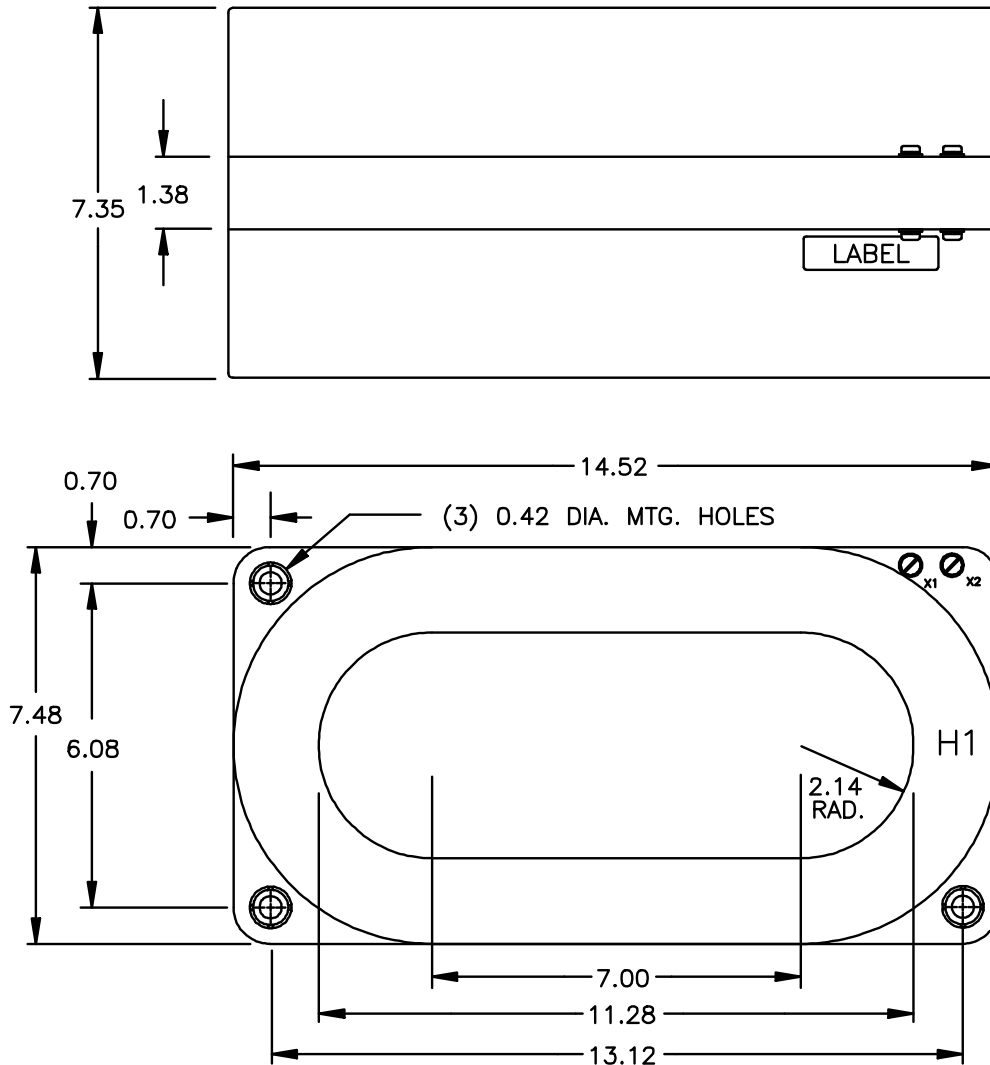

For more information, visit
[gevernova.com/grid-solutions](https://www.gevernova.com/grid-solutions)

Instrument Transformers LLC reserve the right to change specifications of described products at any time without notice and without obligation to notify any person of such changes.

© 2025 GE Vernova and/or its affiliates. All rights reserved. GE and the GE Monogram are trademarks of General Electric Company used under trademark license.



GE VERNOVA

GEA-N50305
English
251010