

MODEL 592

Current Transformer with Cast Resin Construction

Window Size 5.00"x 14.00"

Application

Relaying.

Frequency

50-400 Hz.

Insulation Level

600 Volts, 10 kV BIL full wave.

Model 592

CATALOG NUMBER	CURRENT RATIO	RELAY CLASS	SECONDARY WINDING RESISTANCE (Ω @ 75°C)
592-500	50:5	C15	0.014
592-101	100:5	C30	0.028
592-201	200:5	C60	0.056
592-301	300:5	C100	0.097
592-401	400:5	C120	0.123
592-501	500:5	C150	0.161
592-601	600:5	C200	0.193



Continuous Thermal Current Rating Factor

2.0 at 30°C. amb.,
1.5 at 55°C. amb.

Terminals are brass screws No. 10-32 with one flatwasher and lockwasher.

Approximate weight 150 lbs.

Model 592

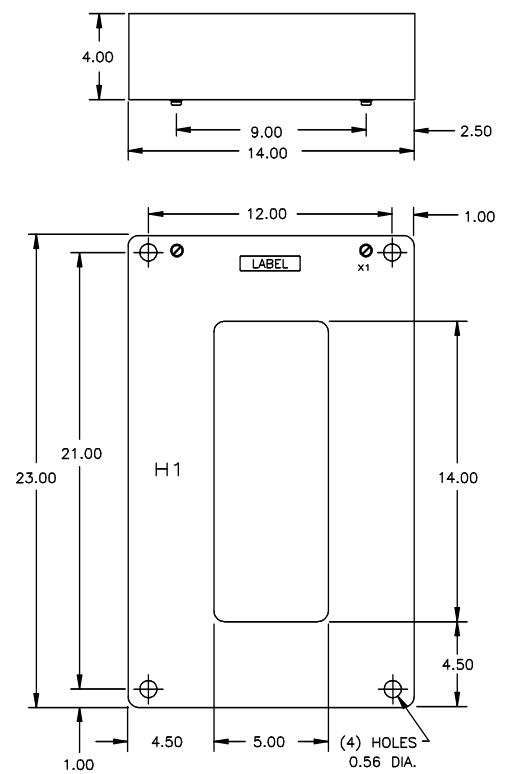
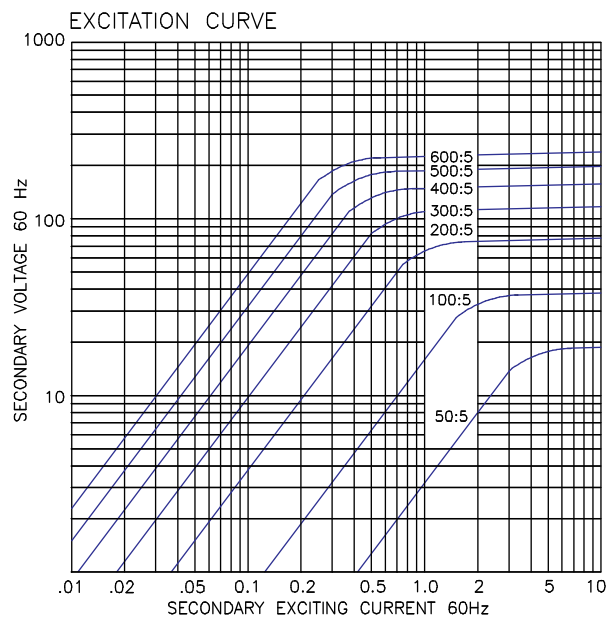

For more information, visit
gevernova.com/grid-solutions

Instrument Transformers LLC reserve the right to change specifications of described products at any time without notice and without obligation to notify any person of such changes.

© 2025 GE Vernova and/or its affiliates. All rights reserved. GE and the GE Monogram are trademarks of General Electric Company used under trademark license.